

**# 13 Grind welding off back side of cam and drive out pin. Replace with nut, bolt & lock washer, to lock motor in desired position.**

**Reuse the original bearing on the new weldment bracket. Lower motor to floor with a pad holder or brush in place to attain level attitude.**

**Tighten bolt to lock**

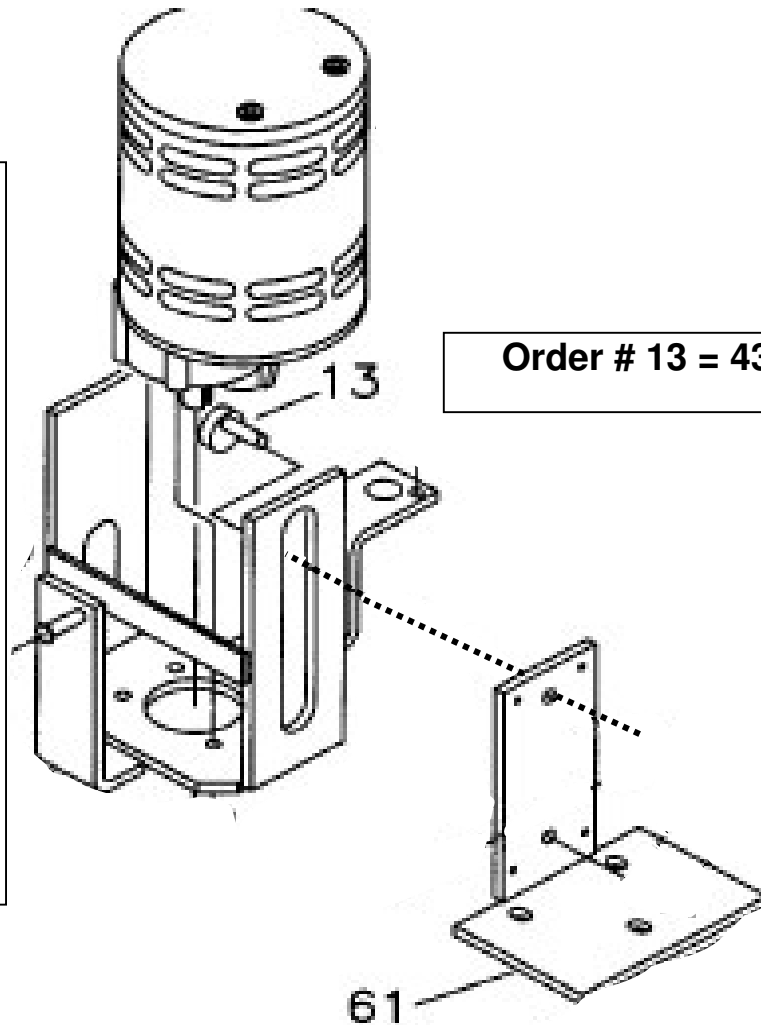

**Order # 13 = 430054**

**Replace # 61 with : 210108 for 200 Models  
430009 for 170 Models  
Note: Bracket shape may vary from illustration**

**NOTE. Bracket shape may vary from illustration**